

# Layout Considerations

## Exercise 6 – Overview

### Unit 6

#### Purpose

The purpose of this exercise is for Students to design a facilities layout given the known services and requirements and several options for plot plans.

#### Objectives

Students will:

- Design a facilities layout map to meet the known services and requirements.

#### Exercise Structure

This exercise will last approximately 1 hour 50 minutes, including individual work and class discussion. It is based on the continuing Charleston flood scenario. On the following pages, the plot plans for two facilities are provided. Each Student will choose one plot plan and design a facilities layout taking into account the known services and requirements. In a guided debriefing, the Instructor will point out the strong points and pitfalls of selected students' work.

#### Rules, Roles, and Responsibilities

Students will work individually for this exercise. The following are the specific activities and instructions for your participation in the exercise:

1. The Logistics Section Chief has informed you that you have two possible locations for use as incident facilities: a school and fairgrounds. Review the plot maps provided on the following pages for the two facilities options.
2. Given the services and requirements that you have identified for the incident site, choose one of the available locations for use as your incident facilities.
3. Draw a facilities map by reproducing your chosen plot plan on a separate sheet of paper and labeling the necessary facilities and work areas.
4. Be prepared to explain your map to the class.

### Exercise 6 Schedule

Activity	Duration	Participation Type
Exercise Introduction and Overview	5 minutes	Classroom
Document	60 minutes	Individual
Debrief and Review	45 minutes	Classroom

# Facilities Option 1: School

## External Layout



Internal Layout

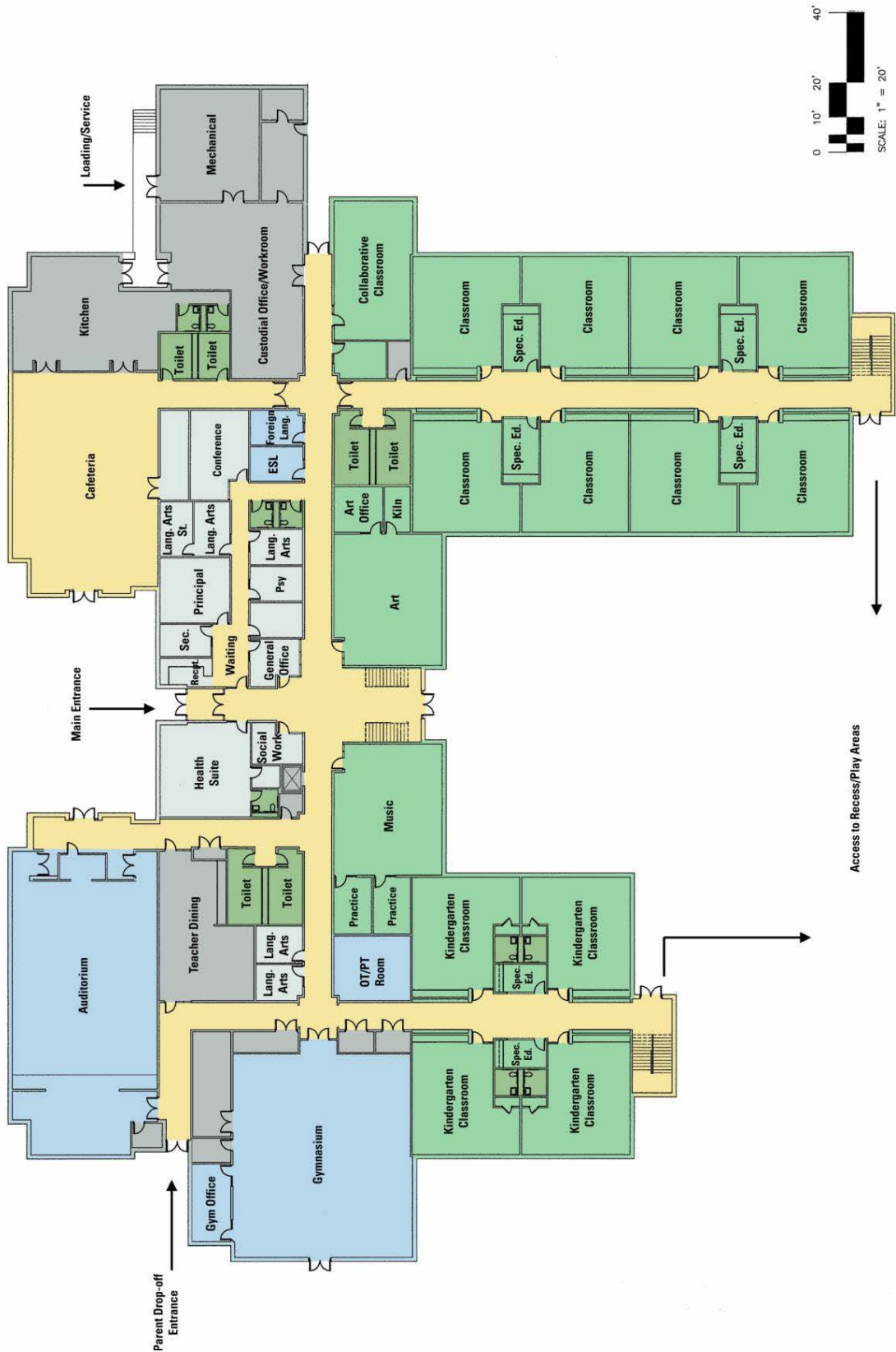

# Facilities Option 2: Fairgrounds

